

Installing your risers

1

Starting at the top step, measure the height and width of the riser.

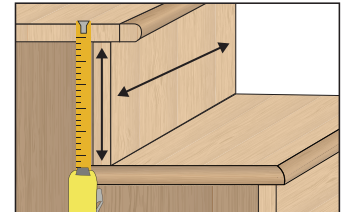

2

Using a miter and table saw, cut the riser to the necessary measurements.

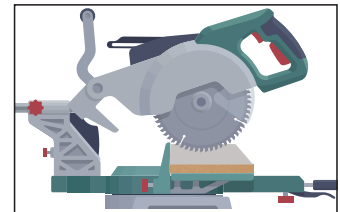

3

Dry fit to ensure a snug fit. (Do NOT force into place).

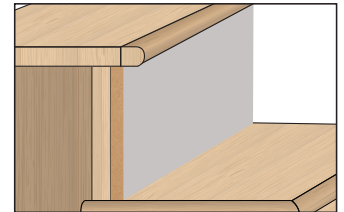

4

Using urethane based construction adhesive, apply a generous "intermittent" bead around the perimeter of the riser and then throughout the middle in a serpentine pattern.

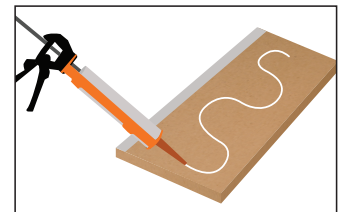

5

Carefully slide your riser into place so it is flush. Push firmly on the riser. (Immediately remove any excess adhesive).

Note: When installing risers on an open-end step, it will be necessary to use a piece of molding to cover the exposed Edge.

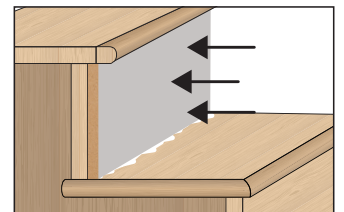

6

REPEAT THE PROCESS FOR EACH STEP.
